

A-dec Dental Face Shield

INSTRUCTIONS FOR USE



Intended Use

Protects the wearer from droplets and spray directly from the oral cavity of the patient during diagnostic and therapeutic treatment.

Features

- Reusable parts
- Low-glare, anti-fog visor design
- Frame sleeves for comfort

How to Reorder

Contact your local authorized A-dec dealer to reorder. Reference the A-dec part numbers (below) for easier ordering:

Item	A-dec p/n	Includes
Complete Shield Kit	91.0017.00	6 visors, 1 frame, and 6 sleeves
Visors	91.0019.00	6 visors
Frame	91.0020.00	1 frame
Sleeves	91.0021.00	6 sleeves

Assemble the Shield

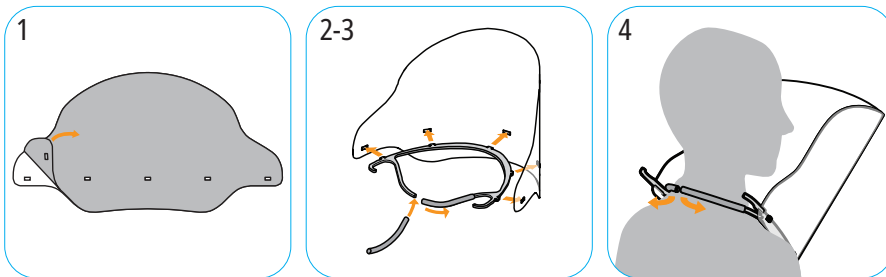

1. Peel off the protective film from both sides of the visor.
2. Snap the frame tabs into the visor cutouts. Start with the outside tabs first.
3. Install the sleeves on the ends of the frame.
4. Separate the frame just enough to fit around your neck and rest the shield on your chest.

Clean and Disinfect

Manually clean with a soft lint-free cloth using a neutral pH, enzymatic detergent or an alkaline pH, non-enzymatic detergent. Follow the instructions provided by the detergent manufacturer.

Manually disinfect using a high-dilution, water-based phenolic formulation or a quaternary ammonium compound formulation with less than 25% isopropanol. Follow the instructions provided by the disinfectant manufacturer.

Inspect the frame for damage (cracks or permanent deformation) and the visor for impaired vision or improper fit on the frame. Replace worn or damaged components as needed.



WARNING Do not use the shield if any component is damaged and cannot be replaced with a new one.

Follow current local regulations governing medical waste to properly dispose of used face shields.

