



A-DEC INC.
2601 CRESTVIEW DRIVE
POST OFFICE BOX 111
NEWBERG, OREGON 97132 USA
TELEPHONE (503)-538-9471

DESIGNATED E.U. REPRESENTATIVE:
A-DEC DENTAL U.K., LTD.
AUSTIN HOUSE
11 LIBERTY WAY
ATTLBOROUGH FIELDS INDUSTRIAL ESTATE
NUNEATON, WARWICKSHIRE
ENGLAND CV116RZ
PHONE: 0800-ADECUK (233285) WITHIN UK
00 44 24 7635 0901 OUTSIDE UK

A-DEC AUSTRALIA
41-43 BOWDEN STREET
ALEXANDRIA, N.S.W. 2015
AUSTRALIA
TELEPHONE (61) 1.800.225010

CHECK WITH LOCAL CODE AUTHORITIES ABOUT INSTALLATION REQUIREMENTS FOR THIS PRODUCT

INSTALLATION INSTRUCTIONS PERFORMER® III CHAIR BACK LINK

YOU WILL NEED

- Hex key set

BEFORE YOU BEGIN

1. Raise the chair base and lower the chair back (see *Figure 1*).
2. Remove the chair seat upholstery.

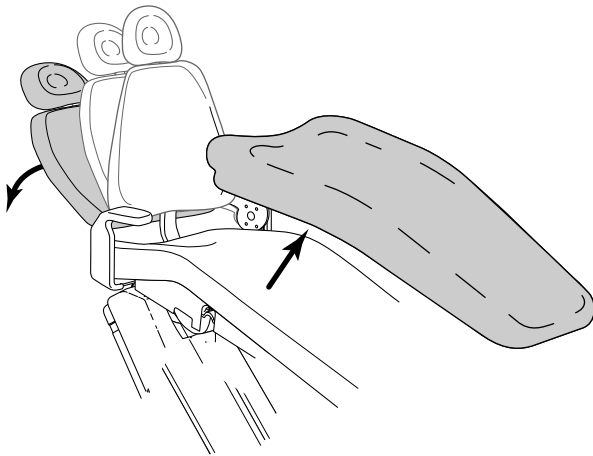

FIGURE 1

REMOVE THE EXISTING BACK LINK

1. Remove the springs from the chair.

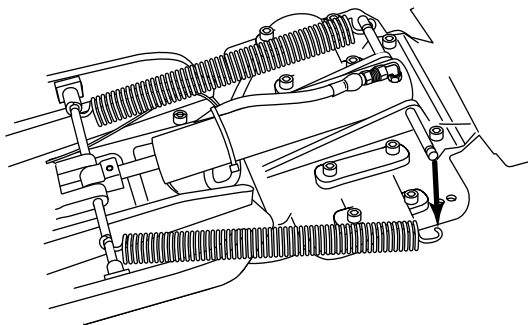
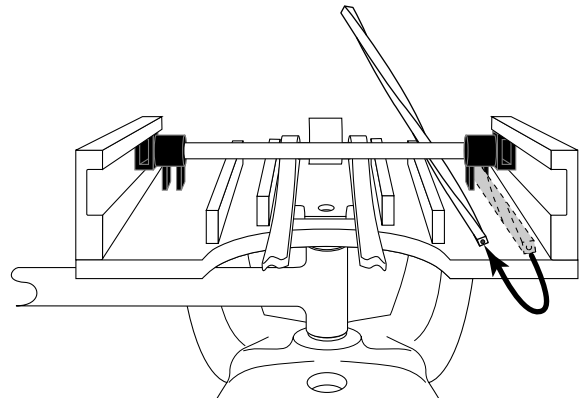

FIGURE 2

2. Disengage the potentiometer drive shaft from the potentiometer by pulling it straight back. Remove it from the chair. Use a footswitch or touch pad to raise the chair back a little, if necessary.



VIEWED FROM THE BACK OF THE CHAIR
FIGURE 3

3. Loosen the setscrew in the back link and both setscrews in the back link lug (near the tilt cylinder).

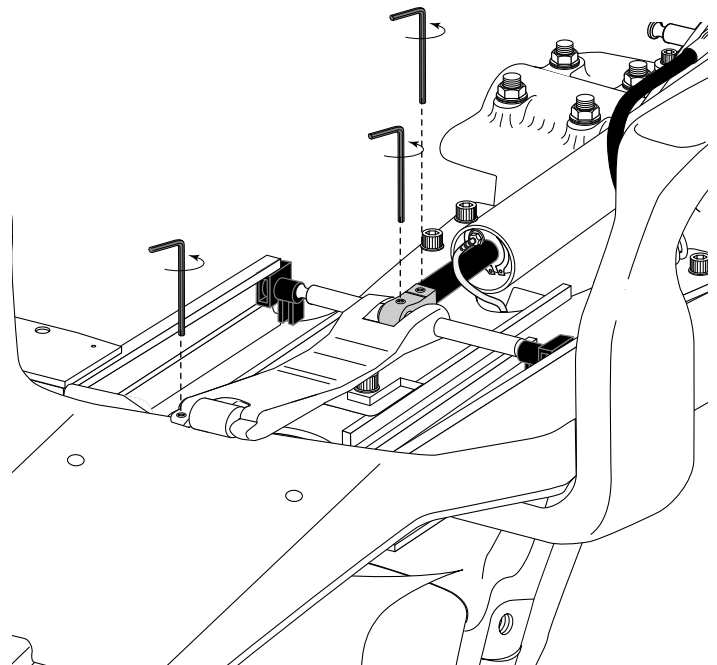

FIGURE 4

4. Remove the back link from the chair back.

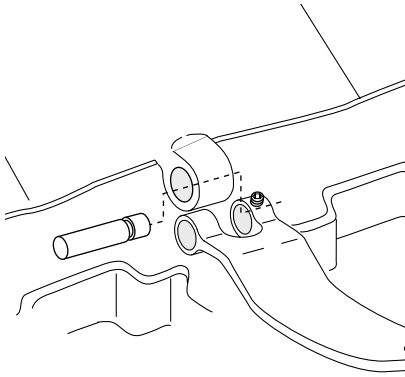

FIGURE 5

5. Remove the back link assembly from the chair tilt cylinder. Rotate the rod to remove the assembly from the chair.

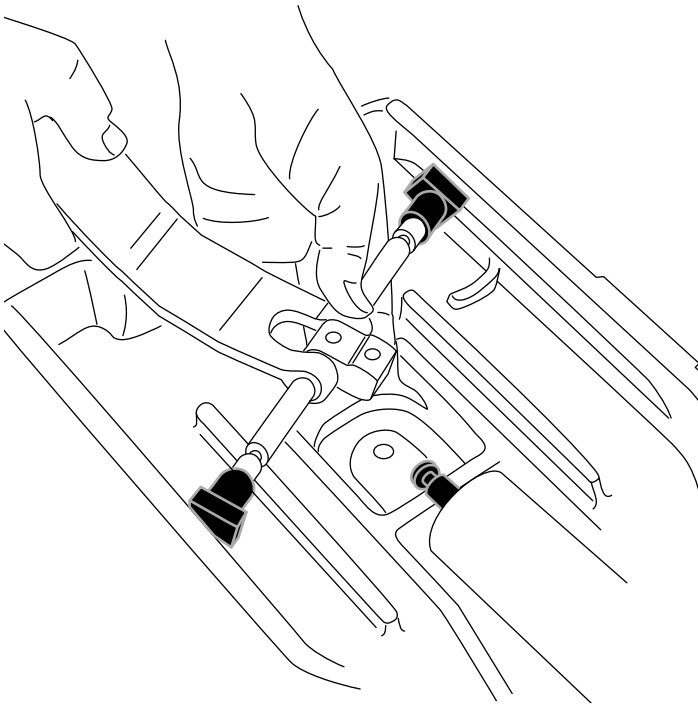

FIGURE 6

6. Disassemble the back link assembly.

INSTALL THE NEW BACK LINK

1. Reassemble the back link assembly using the new back link from the kit.

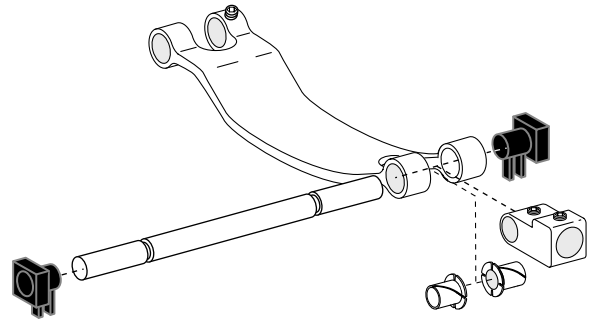

FIGURE 7

2. Rotate the back link rod to align and install the back link lug to the tilt cylinder (see Figures 6 and 8).

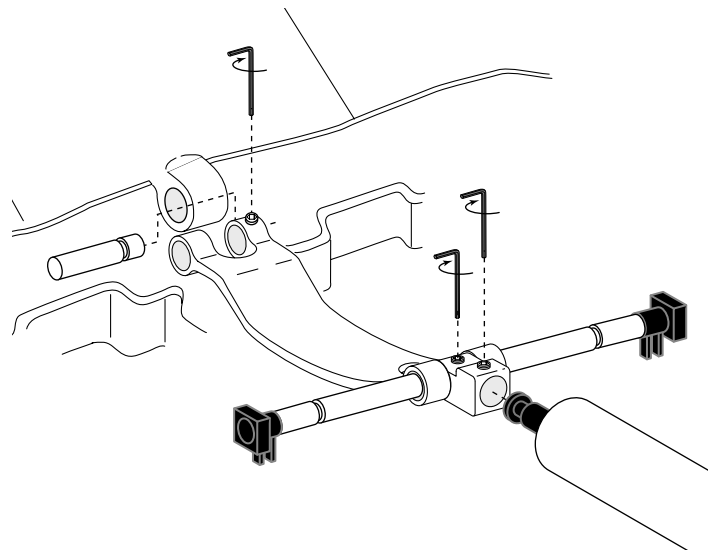
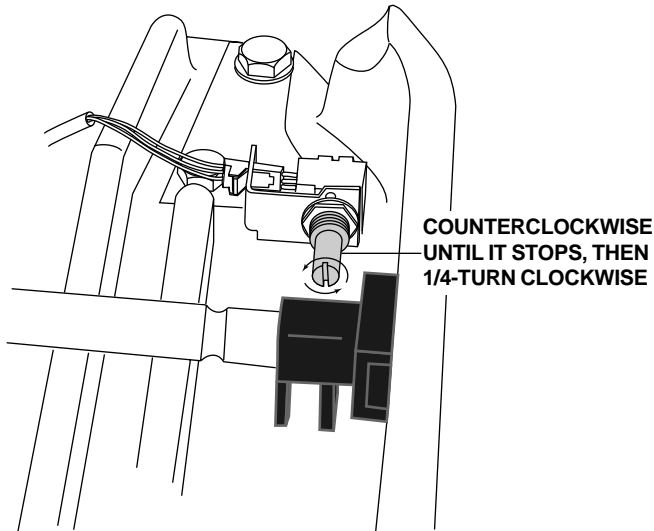

FIGURE 8

3. Connect the back link to the chair back (see Figure 8).
4. Tighten the setscrew in the back link and the two setscrews in the back link lug (see Figure 8).

- Turn the potentiometer counterclockwise until it stops, then turn it clockwise one-quarter turn.



**VIEWED FROM THE BACK OF THE CHAIR
FIGURE 9**

- Use the footswitch or touch pad to raise the chair back until the slider block is about 3 inches (76 mm) from the potentiometer. Insert the potentiometer drive shaft from the **front** of the chair and between the slider block fingers.

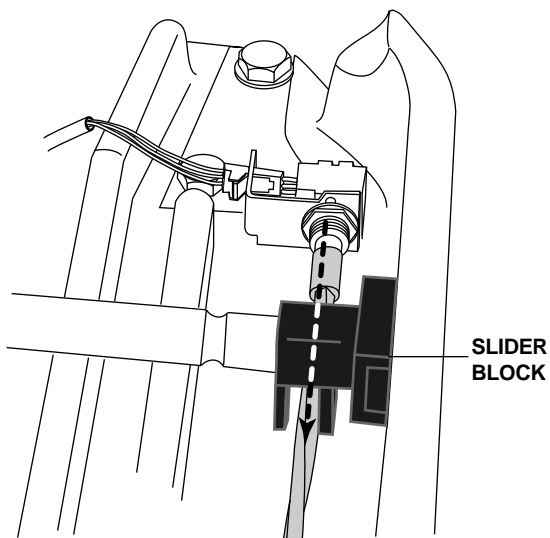

**VIEWED FROM THE BACK OF THE CHAIR
FIGURE 10**

- Use the footswitch or touch pad to lower the chair back fully, then push the potentiometer drive shaft straight into the potentiometer (see Figure 10). **Do not twist** the drive shaft onto the potentiometer.

- Install the springs to the chair.

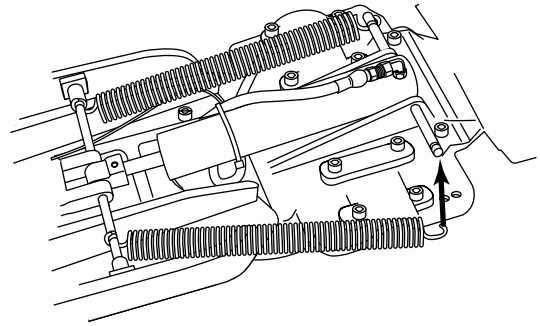

FIGURE 11

TESTING

- Use the chair footswitch or touchpad to activate and check the chair functions.

NOTE

It may be necessary to reprogram the chair pre-programmed positions. Refer to the chair **Owner's Guide** or **A-dec Service Guide** for additional information.

BEFORE LEAVING THE FACILITY

- Reinstall the chair seat upholstery.

